

GENERAL NOTES :-

- THIS DRAWING TO BE READ IN CONJUNCTION WITH ASSOCIATED DRAWINGS & CIVIL SPECIFICATION.
- ANY DISCREPANCIES IN SETOUT OR LEVEL TO BE REPORTED TO THIS OFFICE PRIOR TO CONSTRUCTION.
- CHAINAGES ARE ALONG NEW ROAD CENTRELINES.
- RADII AND DIMENSIONS ARE TO FACE OF KERB.
- ALL KERB RADII ARE AS SPECIFIED.
- REFER TO STORMWATER PLANS FOR NETWORK DETAILS.
- DESIGN LEVELS SHOWN THUS: WT 19.400 REFER TO WATERTABLE.
- ROAD ALIGNMENT & DESIGN LEVELS ARE BASED ON THE SURVEY PERFORMED BY FYFE EARTH PARTNERS REF 18866T04-r2.
- AN AUTOCAD 2D FORMAT DRAWING CAN BE SUPPLIED TO THE CIVIL CONTRACTOR UPON REQUEST FOR SET OUT OF WORKS. THE FILES WILL CONTAIN THE FOLLOWING:
 - EXISTING SURVEY & ASSOCIATED CONTROL. CIVIL CONTRACTOR TO LIAISE WITH ORIGINAL SURVEYOR FOR ANY QUERIES ON EXISTING SURVEY.
 - DESIGN LINWORK & ASSOCIATED DESIGN SERVICES. SET OUT TO BE READ IN CONJUNCTION WITH HARDCOPY DESIGN PLANS & ALLOWANCE MUST BE MADE FOR FILE CONVERSION.
- HOUSE KERB OUTLETS (KERB OUTLETS) ARE TO BE PROVIDED IN A KERB LOW SIDE OF EACH ALLOTMENT POSITIONED 0.5m FROM THE SIDE BOUNDARY.
- STORMWATER PIPE DEFLECTIONS SHOWN ARE INDICATIVE ONLY. CONTRACTOR NOT TO EXCEED PIPE MANUFACTURERS SPECIFICATION.
- THE CONTRACTOR SHALL BE RESPONSIBLE FOR THE FOLLOWING DURING CONSTRUCTION.
 - PRESERVATION AND CARE OF EXISTING TREES/VEGETATION ALONG COUNCIL RESERVE AND WHERE INDICATED.
 - REINSTATEMENT OF EXISTING DRIVEWAYS, STORMWATER CROSSINGS, VERGE, ETC. TO COUNCIL AND SUPERINTENDENTS SATISFACTION.
 - ANY DAMAGE TO EXISTING UNDERGROUND INFRASTRUCTURE CAUSED DURING THE CONTRACT.
- ALL INTERFACES WITH NEW WORKS ARE TO BE SAWCUT.
- THE CONTRACTOR SHALL BE RESPONSIBLE FOR ALL TRAFFIC MANAGEMENT FOR THE DURATION OF THE CONTRACT WORKS. MINIMUM DISRUPTION IS ESSENTIAL & A TRAFFIC PLAN MUST BE SUBMITTED TO COUNCIL FOR APPROVAL.
- ALL SIGNAGE & LINEMARKING TO BE INSTALLED IN ACCORDANCE WITH CURRENT REGULATIONS OF THE ROAD TRAFFIC ACT & THE REQUIREMENTS FOR TRAFFIC CONTROL DEVICES. REFER AS1742.2-CURRENT EDITION. TRAFFIC CONTROL DEVICES TO BE INSTALLED IN ACCORDANCE WITH AS 1742 - 'MANUAL OF UNIFORM TRAFFIC CONTROL SET' AS MODIFIED BY THE DPTI 'MANUAL OF LEGAL RESPONSIBILITIES AND TECHNICAL REQUIREMENTS FOR TRAFFIC CONTROL DEVICES' IN CONJUNCTION WITH THE DPTI 'PAVEMENT MARKING MANUAL'.
- CONTRACTOR TO MAKE ALLOWANCE FOR REMOVAL OF ALL EXISTING TREES, SHRUBS, FENCING, UNDERGROUND SERVICES & BUILDING MATERIALS OFFSITE TO PROVIDE A CLEAR & UNOBSTRUCTED ALLOTMENTS EXCEPT WHERE INDICATED. ANY BACKFILLING TO BE REMEDIATED AS PER BLOCK FILL SPECIFICATION. ALL NECESSARY APPROVALS TO BE GRANTED PRIOR TO DEMOLITION. REFER ARBORIST REPORT FOR ADDITIONAL INFORMATION ON SITE MANAGEMENT AND PROTECTION MEASURE OF SIGNIFICANT TREES INDICATED.
- THE CIVIL CONTRACTOR MUST HYDRO SEED ALL ALLOTMENTS, VERGE & DISTURBED AREAS PRIOR TO PRACTICAL COMPLETION. CONFIRMATION OF EXTENTS TO BE ADVISED FROM SUPERINTENDENT & DEVELOPER PRIOR TO APPLICATION.
- THE CIVIL CONTRACTOR MUST LIAISE WITH ADJACENT RESIDENTS PRIOR TO CONSTRUCTION.
- PRIOR TO THE START OF CIVIL CONSTRUCTION WORKS. THE CIVIL CONTRACTOR IS TO PROVIDE A DILAPIDATION REPORT FOR ABUTTING DWELLINGS, AND COUNCIL ROAD RESERVES TO BE USED DURING THE CIVIL CONTRACT.
- ANY FENCING REQUIRED FOR REMOVAL DURING THE CONTRACT MUST HAVE TEMPORARY FENCING ERECTED AND MAINTAINED UNTIL NEW FENCING IS ERECTED BY THE CONTRACTOR OR CLIENT.
- IT IS THE RESPONSIBILITY OF THE CIVIL CONTRACTOR TO PROVIDE THE APPROPRIATE SIGNAGE AND FENCING TO ENSURE A SAFE WORK ENVIRONMENT FOR CONTRACTORS AND THE GENERAL PUBLIC.
- AT ALL PROPOSED SAPN SERVICE PILLAR LOCATIONS, WHERE THE FINISHED GROUND LEVEL WILL BE STEEPER THAN 1 IN 8 GRADIENT, THE CIVIL CONTRACTOR MUST PREPARE A MINIMUM 1m x 1m 'SAFE OPERATING WORKING ZONE' AT THE REAR & OPEN SIDE FROM THE SERVICE PILLAR EDGE, PRIOR TO BATTER OR RETAINING STRUCTURE. REFER TO TS-085 CLAUSE 7.6 & THE APPROVED ELECTRICAL DESIGN DOCUMENTS.
- 50mm CONDUIT TO BE PLACED UNDER FOOTPATH FOR EACH ALLOTMENT GENERALLY CENTRAL. REFER DETAIL SHEET.

SPECIFICATION FOR BLOCK FILLING

STRIP VEGETATION/TREES FROM ENTIRE AREA TO BE FILLED & REMOVE OFFSITE. (EXCEPT TREES INDICATED)

ENSURE ALL TREE ROOTS ARE REMOVED TO A MIN. 600mm BELOW EXISTING SURFACE.

STRIP AND STOCKPILE TOPSOIL FOR FUTURE REUSE.

STRIP ANY EXISTING FILLING & STOCKPILE FOR RE-USE.

THE GITA & SUPERINTENDENT IS TO INSPECT THE EXPOSED NATURAL SURFACE AFTER STRIPPING AND INSPECT THE COMPACTED NATURAL SURFACE, PRIOR TO PLACEMENT OF REQUIRED FILLING. PROOF ROLLING WITH A FILLED WATER CART SHALL BE REQUIRED.

THE NATURAL GROUND SURFACE EXPOSED AFTER STRIPPING SHALL BE COMPACTED TO A MINIMUM OF 98% STANDARD DRY DENSITY TO AS1289.5.1.1 TO A DEPTH OF NOT LESS THAN 150 mm. THIS MAY REQUIRE ADDITIONAL WORK SUCH AS RIPPING AND WATERING, FOR EXAMPLE PRIOR TO ROLLING.

WHERE FILLING ABUTS SLOPING GROUND, BENCHES SHOULD BE CUT IN THE GROUND GREATER THAN 1 IN 8 SLOPE TO ASSIST PLACING THE FILL, AND TO KEY INTO THE NATURAL FOUNDATION. THE BENCHES SHOULD BE SHAPED TO PROVIDE FREE DRAINAGE. THE DEPTH OF BENCH SHOULD BE NOT LESS 300mm; HOWEVER, IT MAY VARY DEPENDING ON THE NATURAL SLOPE OF THE GROUND, THE NATURE, AND THE EQUIPMENT BEING USED. DIRECTION FROM THE GITA IS ESSENTIAL FOR CERTIFICATION.

THE CIVIL CONTRACTOR IS RESPONSIBLE FOR PROCESSING & SORTING ALL FILL MATERIALS TO ENSURE THEY ARE FREE FROM ALL RUBBISH. NO FILL WILL BE ACCEPTED AS 'CLEAN' FILL IF IT CONTAINS FOREIGN MATERIALS.

BUILD UP TO FINISHED SURFACE LEVELS AS SHOWN ON THIS SHEET IN 200mm LOOSE LAYER USING SELECTED SOIL FROM THE SITE & APPROVED MATERIAL, FREE FROM STONE OR LUMPS GREATER THAN 150mm AND PLACED AT 0.M.C. ± 2%. NO HIGHLY REACTIVE CLAYS SHALL BE ACCEPTED BY THE SUPERINTENDENT. ANY PLACEMENT OF FILLING TO STOP WITHIN 100mm OF FINISHED LEVEL INDICATED, TO ALLOW FOR 100mm LAYER OF TOPSOIL. THE CONTRACTOR SHALL TAKE PARTICULAR CARE AND USE APPROPRIATE STATIC DRUM ROLLERS NEAR EXISTING FENCE LINES TO PROTECT ADJACENT RESIDENCES.

GENERALLY COMPACTION TESTING IS TO BE CARRIED OUT BY THE GITA. IN ACCORDANCE WITH LEVEL 1 OF SECTION 8 OF AS3798-2007 (CURRENT EDITION). THE LOCATION OF THE TEST IS TO BE AT THE DISCRETION OF THE GITA. BUT GENERALLY ONE TEST PER LAYER PER 1000m² WITH A MINIMUM OF THREE TESTS PER VISIT. COMPACTION IS TO ACHIEVE 95% STANDARD TO AS1289.5.1.1 ON A 'NOT ONE TO FAIL' BASIS. THE LOCATION, TEST NUMBER, AND RELATIVE LEVEL OF EACH TEST TO BE RECORDED, BY THE GITA, ON THIS PLAN SUPPLIED BY THE CONTRACTOR.

A COMPACTION TEST IS TO BE TAKEN ON ALL ALLOTMENTS AT FINISHED LEVEL, ADDITIONAL TO ANY TESTING PREVIOUSLY MENTIONED.

FILLING SURFACE IS TO BE FINISHED AT +/- 25mm FROM DESIGN LEVELS.

THE CONTRACTOR SHALL BE RESPONSIBLE FOR NOTIFYING THE GITA. WHEN THE WORKS ARE READY FOR TESTING GIVING A MINIMUM OF 12 HOURS NOTICE. THE CONTRACTOR SHALL PAY FOR FAILED TESTS.

ALL FILL BATTERS NOT HATCHED SHALL BE CONTROLLED FILLED. GITA TO DOCUMENT EXTENT WITHIN CERTIFICATION DOCUMENTATION.

REFER SHEET C3

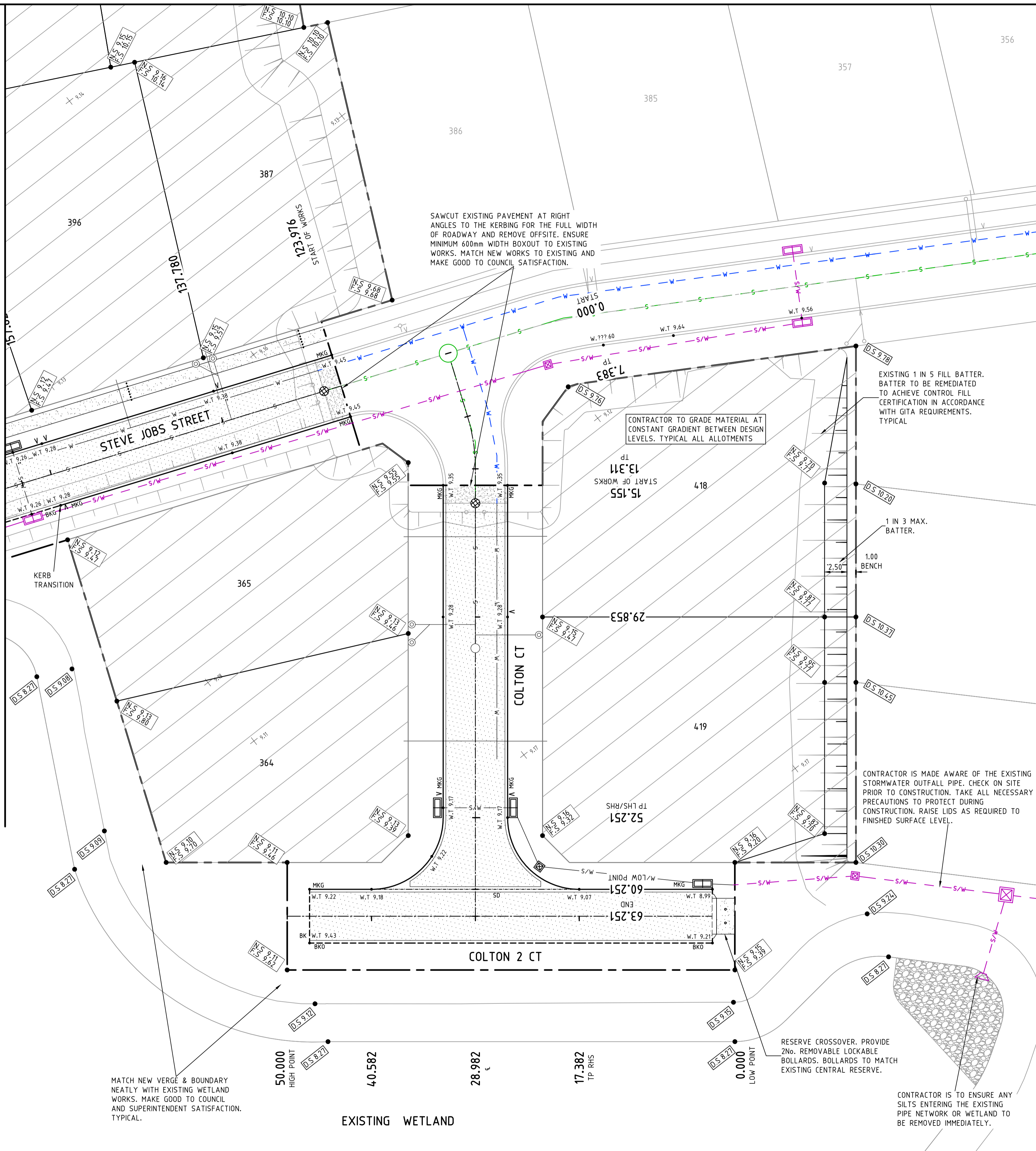

LEGEND

- EXISTING SURFACE LEVEL
- EXISTING SURFACE CONTOUR
- EXTENT OF HOTMIX PAVEMENT
- FOOTPATH REFER STD DETAIL SHEET, SD-205, & SD-210
- PRAM RAMP REFER STD DETAIL SD-125, SD-130, & SD-200
- EXTENT OF BLOCK FILLING AS PER SPECIFICATION
- MOUNTABLE KERB ONLY REFER STD DETAIL SHEET
- MOUNTABLE KERB & GUTTER REFER STD DETAIL SHEET
- MOUNTABLE KERB & OUTFALL GUTTER REFER STD DETAIL SHEET
- BARRIER KERB & GUTTER REFER DETAIL SD-100
- BARRIER KERB & OUTFALL GUTTER REFER DETAIL SD-100
- BARRIER KERB ONLY REFER DETAIL SD-100
- CONCRETE SPOON DRAIN REFER DETAIL SD-100
- CONCRETE EDGE STRIP REFER DETAIL SD-100
- DRIVEWAY INVERT & CROSSOVER REFER STD DETAIL SHEET
- STAGE BOUNDARY
- N.S. xx.xx NATURAL SURFACE LEVEL
- F.S. xx.xx FINISHED SURFACE LEVEL
- W.T. xx.xx WATERTABLE LEVEL
- B.B. xx.xx BOTTOM BANK LEVEL
- T.B. xx.xx TOP BANK LEVEL
- D.S. xx.xx EX. STAGE DESIGN SURFACE LEVEL
- E.B. xx.xx EDGE OF BITUMEN
- STORMWATER KERB OUTLET. REFER STD DETAIL SD-115, SD-120, & SD-380
- PRECAST SIDE ENTRY PIT REFER STD DETAIL SHEET
- PRECAST GRATED INLET PIT REFER STD DETAIL SD-305
- EXISTING SEWER MAIN - GRAVITY
- EXISTING SEWER PUMPING MAIN
- EXISTING POTABLE WATER MAIN
- EXISTING RECLAIMED WATER MAIN
- EXISTING STORMWATER DRAIN
- EXISTING TELECOMMUNICATIONS
- EXISTING ELECTRICAL
- EXISTING OVERHEAD ELECTRICAL
- EXISTING GAS MAIN
- SEWER MAIN
- POTABLE WATER MAIN
- STORMWATER DRAIN
- COMMON SERVICE TRENCH
- IRRIGATION CONDUIT REFER STD DETAIL SHEET
- CONCRETE UPSTAND 150x x MAX. 300H OR CONCRETE KENSINGTON SLEEPER
- RETAINING WALL WITH INDICATIVE BENCH LEVEL DIFFERENCE NOMINATED. TOP OF WALL MUST BE 50mm ABOVE F.S.L. TO REAR BOUNDARIES AND 150mm ABOVE F.S.L. TO SIDE BOUNDARIES. REFER SPECIFICATION FOR RETAINING WALL DETAIL.

PLAN

SCALE 1:250

NOTE :-
THE CONTRACTOR IS RESPONSIBLE FOR LOCATING AND DEPTHING OF ALL EXISTING SERVICES PRIOR TO ANY CONSTRUCTION COMMENCING. ALL TRENCHING TO BE REINSTATED TO THE SATISFACTION OF THE RELEVANT AUTHORITIES.

Herriot consulting
civil & structural engineers

1/154 Fullarton Road Rose Park SA 5067
P: 08 8431 4555 E: admin@herriot.com.au W: herriot.com.au

No.	REVISION	BY	DATE
1	BOUNDARY AMENDMENTS	JT	13/04/23
0	APPROVED FOR CONSTRUCTION		17/03/23
B	ISSUED FOR APPROVAL	JT	13/01/23
A	CLIENT REVIEW	JT	16/12/22

DRAWN: BJB
DESIGNED: BJB
CHECKED: JT
SHEET SIZE: A1

SCALE: 1:250

DATE: / / 2022

PREPARED FOR:
HICKINBOTHAM DEVELOPMENTS PTY LTD
LIBERTY ESTATE STAGE 9, TWO WELLS
D.N 312/D001/14
GENERAL CONSTRUCTION PLAN

DATE OF ISSUE: **DECEMBER 2022**

FILE No.: **2208-116**

SHEET: **C2** Rev. **1**